

THE UNIVERSITY OF GEORGIA[®]

SPIA

SCHOOL OF PUBLIC &
INTERNATIONAL AFFAIRS

PolMeth XXXI

31st Annual Summer Meeting Society for Political Methodology July 23–26, 2014

The Department of Political Science at the University of Georgia is pleased to host the 31st annual summer meeting of the Society for Political Methodology. This program is supported in part by the President's Venture Fund through the generous gifts of the University of Georgia Partners and other donors. The meeting also has been sponsored by the Philip H. Alston Jr. Fund, the National Science Foundation, the office of the University of Georgia Vice President for Research, the School of Public and International Affairs at the University of Georgia, the Graduate School at the University of Georgia, Springer Press, Cambridge University Press, and the Society for Political Methodology. This document contains a schedule and other details about the conference. If you have questions, please visit the website (<http://spia.uga.edu/polmeth/>) or contact a local graduate student or conference host. Enjoy your time in Athens! *Last update: July 23, 2014*

Conference Hosts

- **Keith Poole**, *University of Georgia*
- **Ryan Bakker**, *University of Georgia*
- **Inés Levin**, *University of Georgia*
- **Jamie Monogan**, *University of Georgia*

Program Committee

- **Keith Poole** (chair), *University of Georgia*
- **Kevin Quinn** (ex officio), *University of California, Berkeley*
- **Jeff Gill**, *Washington University in Saint Louis*
- **Jeff Jenkins**, *University of Virginia*
- **Inés Levin**, *University of Georgia*
- **Suzie Linn**, *Pennsylvania State University*
- **Jamie Monogan**, *University of Georgia*
- **Maya Sen**, *Harvard University*
- **Andy Whitford**, *University of Georgia*

Georgia Center Room Information:

Registration: Hill Atrium (outside Mahler)
All Refreshment Breaks: Hill Atrium
Breakfast on Thurs-Sat: Hill Atrium
Lunch on Thurs-Fri, Dinner Fri: Magnolia Ballroom
Lunch on Sat: Dogwood Hall
Paper sessions: Room KL (Second Floor) and Mahler Auditorium.
The Georgia Center is handicap-accessible.

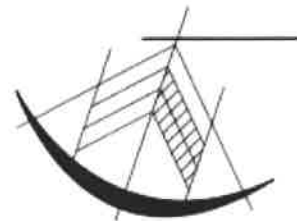

**THE SOCIETY FOR
POLITICAL METHODOLOGY**

ad indicia spectate

Schedule - All Rooms are in the Georgia Center

Wednesday, July 23: Arrival and Hotel Check-In

7:00pm Women's Dinner. RSVPed guests depart Pecan Tree Galleria, 6:30. Inés Levin & Stefanie Lindquist, hosts.

Thursday, July 24

7:30am	Breakfast and Registration	Hill Atrium
9:00	Opening Remarks	Mahler
9:30	<u>Session I</u> "Modeling Unobserved Heterogeneity in Network Formation" Janet Box-Steffensmeier , <i>Ohio State University</i> , Dino Christenson , <i>Boston University</i> , and Jason Morgan , <i>Ohio State University</i> Discussant: Arturas Rozenas , <i>New York University</i>	Mahler
	"A Survey Instrument Design Approach to the Analysis of Texts" Justin H. Gross , Kelsey Shoub , Andrew Tyner , and Amy Sentementes <i>University of North Carolina at Chapel Hill</i> Discussant: Scott Moser , <i>University of Texas</i>	KL
10:50	Break	Hill Atrium
11:10	<u>Session II</u> "Computer-Assisted Keyword & Document Set Discovery from Unstructured Text" Gary King , <i>Harvard University</i> , Patrick Lam , <i>IQSS, Harvard University</i> , and Margaret Roberts , <i>University of California, San Diego</i> Discussant: Burt Monroe , <i>Pennsylvania State University</i>	Mahler
	"Estimating Posttreatment Effect Modification with Generalized Structural Mean Models" Luke Keele , <i>Pennsylvania State University</i> Discussant: Neil Malhotra , <i>Stanford University</i>	KL
12:30pm	Lunch. 12:50 : Roundtable on Diversity within the Society, by Maya Sen (moderator), Emily Beaulieu, Janet Box-Steffensmeier, Justin Esarey, and Kevin Quinn.	Magnolia Ballroom
2:00	<u>Session III</u> "Design, Identification, and Sensitivity Analysis for Patient Preference Trials" Dean Knox , <i>MIT</i> , Teppei Yamamoto , <i>MIT</i> , Matthew A. Baum , <i>Harvard University</i> , and Adam Berinsky , <i>MIT</i> Discussant: David Nickerson , <i>University of Notre Dame</i>	Mahler
	"You're Going to Need a Bigger Model: Error Correction Methods with Political Time Series" Taylor Grant and Matthew Lebo , <i>Stony Brook University</i> Discussant: Neal Beck , <i>New York University</i>	KL
3:20	Break	Hill Atrium
3:40	<u>Session IV</u> "Bayesian Population Interpolation and Lasso-Based Target Selection in Survey Weighting" Devin Caughey and Mallory Wang , <i>Massachusetts Institute of Technology</i> Discussant: James Honaker , <i>IQSS, Harvard University</i>	Mahler
	"Detecting Direct Effects and Assessing Alternative Mechanisms" Avidit Acharya , <i>Stanford University</i> , Matthew Blackwell , <i>Harvard University</i> , and Maya Sen , <i>Harvard University</i> Discussant: Allan Dafoe , <i>Yale University</i>	KL
5:00	Business Meeting	Mahler
6:00	Graduate Student Poster Session and Reception for All Registered Attendees	Hill Atrium/Pecan Tree Galleria
7:30	Adjourn. See website for dinner and nightlife suggestions. Informal gathering at 7:30 in the Hill Atrium to walk downtown with a group.	Hill Atrium

Friday, July 25

7:30am	Breakfast	Hill Atrium
<u>9:30</u>	<u>Session V</u>	
	“Towards a Data-Driven Voter Guide: Adapting Methods for Quantitatively Measuring Political Preferences to Help Voters Learn about Candidates”	Mahler
	Adam Bonica , <i>Stanford University</i>	
	Discussant: Arthur Spirling , <i>Harvard University</i>	
	“An Extreme-Scale Computational Approach to Redistricting Optimization”	KL
	Wendy K. Tam Cho , <i>University of Illinois at Urbana-Champaign</i>	
	Discussant: Carlisle Rainey , <i>University at Buffalo (SUNY)</i>	
10:50	Break	Hill Atrium
<u>11:10</u>	<u>Session VI</u>	
	“Robust Nonparametric Confidence Intervals for Regression-Discontinuity Designs”	Mahler
	Rocío Titunik , <i>University of Michigan</i>	
	Discussant: Jeff Harden , <i>University of Colorado</i>	
	“Do Survey Experiments Capture Real-World Behavior? Evaluating the External Validity of Conjoint and Vignette Analysis”	KL
	Jens Hainmueller , <i>Stanford University</i> , Dominik Hangartner , <i>London School of Economics</i> , and Teppei Yamamoto , <i>Massachusetts Institute of Technology</i>	
	Discussant: Ryan Bakker , <i>University of Georgia</i>	
12:30pm	Lunch. 12:50 : Lunch discussion of <i>Political Analysis</i> , led by Neal Beck.	Magnolia Ballroom
2:00	Faculty Poster Session	Hill Atrium
<u>3:00</u>	<u>Session VII</u>	
	“A New Automated Redistricting Simulator Using Markov Chain Monte Carlo”	Mahler
	Benjamin Fifield , Michael Higgins , and Kosuke Imai , <i>Princeton University</i>	
	Discussant: Jowei Chen , <i>University of Michigan</i>	
	“Mirrors for the Princes and Sultans: Advice on the Art of Governance in the Medieval Christian and Islamic Worlds”	KL
	Justin Grimmer , <i>Stanford University</i>	
	Discussant: Hanna Wallach , <i>University of Massachusetts, Amherst</i>	
4:20	Break	Hill Atrium
<u>4:40</u>	<u>Session VIII</u>	
	“Why You Should (Usually) Post-Stratify on Sample Weights in Survey Experiments”	Mahler
	Luke Miratrix , <i>Harvard University</i> , Jasjeet Sekhon , <i>University of California, Berkeley</i> , and Alexander Theodoridis , <i>University of California, Merced</i>	
	Discussant: Christopher Fariss , <i>Pennsylvania State University</i>	
	“Publication Bias in Political Science: Using TESS Experiments to Unlock the File Drawer”	KL
	Neil Malhotra , <i>Stanford University</i>	
	Discussant: Maya Sen , <i>Harvard University</i>	
6:00	Dinner for All Registered Attendees	Magnolia Ballroom
8:00	Adjourn. See website for nightlife suggestions.	Hill Atrium
	Informal gathering at 8:00 in the Hill Atrium to walk downtown with a group.	

Saturday, July 26

7:30am	Breakfast	<i>Hill Atrium</i>
<u>9:30</u>	<u>Session IX</u>	
	“Positive Empirical Models of Election Fraud (That May Also Measure Voters’ Strategic Behavior)”	<i>Mahler</i>
	Walter Mebane, Naoki Egami, Joseph Klaver, and Jonathan Wall, University of Michigan	
	Discussant: Chris Warshaw, Massachusetts Institute of Technology	
	“Political Persuasion in the Field: Evidence from the 2012 Obama Re-election Campaign.”	<i>KL</i>
	David Nickerson, University of Notre Dame	
	Discussant: Rocío Titiunik, University of Michigan	
10:50	Break	<i>Hill Atrium</i>
<u>11:10</u>	<u>Session X</u>	
	““The Most Expensive Voter Mobilization Effort in American Politics?”: Bias in Turnout Estimate in the American National Election Studies”	<i>Mahler</i>
	Simon Jackman, Stanford University	
	Discussant: Robert Erikson, Columbia University	
	“A Sparse Decomposition of Democracy and Trade”	<i>KL</i>
	In Song Kim, Massachusetts Institute of Technology, John Londregan, Princeton University, and Marc Ratkovic, Princeton University	
	Discussant: Curtis Signorino, University of Rochester	
12:30pm	Lunch	<i>Dogwood Hall</i>

Graduate Student Posters (Thursday, 6:00pm)

Applications in American Institutional Research

Discussant: **Chris Kypriotis**, *Warren Wilson College*

1. "Venue Choice and Firm Influence in Regulatory Politics." **Ben Fifield**, *Princeton University*
2. "OIRA: The Other Edge of the Sword." **Janna Rezaee**, *University of California, Berkeley*
3. "Field of Forces: Strategic Interdependence in Legislative Behavior." **Emily Schilling**, *University of Iowa*
4. "A Hierarchical Latent Space Network Model for Judicial Citations." **Anton Strezhnev**, *Harvard University*
5. "Estimating Statutory Change in U.S. Legislation, 1977-2004." **Miranda Yaver**, *Columbia University*

Applications in Campaigns and Elections

Discussant: **Jason Windett**, *Saint Louis University*

6. "Polarization in Primary Electorates." **Rachel Bitecofer**, *University of Georgia*
7. "Voters Always Rally Round the Flag? Ex-ante War Costs, Psychological Bias, and Vote Choice." **Kiyoung Chang**, *University of Maryland*
8. "What Happens When Extremists Win Primaries?" **Andrew Hall**, *Harvard University*
9. "Ecological Inference with Vote-Share Data." **Dorothy Kronick**, *Stanford University*
10. "Political Dynasties as the Electoral Strategy of Parties: Evidence from India." **Carlos Velasco**, *Princeton University*

Applications in Comparative Politics

Discussant: **Santiago Olivella**, *University of Miami*

11. "Better to Stand Alone? Estimating Contamination Effects in the 2008 South Korean Parliamentary Election." **Shinhye Choi**, *University of California, Berkeley*
12. "The Effects of Candidate Attributes in Africa: A Fully-Randomized Conjoint Analysis for Facebook Users in Kenya and Uganda." **Hyesung Kim**, *University of Rochester*
13. "Do Political Shocks Increase Ritual Violence: Evidence from Medicine Murders in Lesotho and Witch-hunts in Scotland." **Parashar Kulkarni**, *New York University*
14. "The Latent Path Model for Dynamic Social Networks with an Application to Party Switching in Poland." **Jason Morgan**, *Ohio State University*
15. "Using the Predicted Responses from List Experiments as Explanatory Variables in Regression Models." **Bethany Park**, *Princeton University*

Bayesian Methods

Discussant: **Gaurav Sood**, *Stanford University*

16. "Bayesian Shrinkage for Dynamic Models: A Flexible Method to Handle Smooth and Sharp Changes in Parameters over Time." **Jeffrey Arnold**, *University of Rochester*
17. "Measuring Citizens' Ideological Perceptions of Candidates and Legislators." **Chris Hare**, *University of Georgia*
18. "The General Bayesian Approach for the Estimation of the Varying Choice Logistical Model." **Elena Labzina**, *Washington University in Saint Louis*
19. "National Human Rights Institutions: Domestic Implementation of International Law." **Ryan Welch**, *Florida State University*

Bayesian Multilevel Models

Discussant: **Xun Pang**, *Tsinghua University*

20. "Generating Executive Incentives: The Role of Domestic Politics in International Human Rights Court Effectiveness." **Jillienne Haglund**, *Florida State University*
21. "Understanding Immigrants' Political Participation: a Bayesian Multilevel Approach." **Brad Jones** and **Ruoxi Li**, *University of Wisconsin, Madison*
22. "Electoral Proximity and Constituent Evaluations of U.S. Senators: An Application of Multilevel Bayesian Models." **Joel Sievert**, *University of Georgia*
23. "A Multilevel Bayesian Measurement Model of Political Risk for FDI." **Jane Sumner**, *Emory University*

Causal Inference

Discussant: **Inés Levin**, *University of Georgia*

24. "Covariate Balancing Propensity Scores for Multi-Valued Treatment Regimes." **Christian Fong**, *Princeton University*
25. "Political Elites, Economic Interests, and Fiscal Capacity—The Development of Tax Revenue in 19th Century Prussia." **Florian Hollenbach**, *Duke University*
26. "Identifying Peer Effects under Homophily with an Instrumental Variable: Patronage and Promotions in the Chinese Bureaucracy." **Dean Knox**, *Massachusetts Institute of Technology*
27. "Three Approaches to Estimation and Statistical Tests for Nonlinear Difference-in-Differences Models." **Taeyong Park**, *Washington University in Saint Louis*
28. "Causal Mechanisms and Explanation: Does Opening the Black Box Help?" **Tess Wise**, *Harvard University*

Computational Research

Discussant: **Radhika Saksena**, *Princeton University*

29. "Spending Swept Under the Rug: Inferring Political Ideology of Ostensibly Non-partisan Organizations." **Drew Dimmery** and **Andrew Peterson**, *New York University*
30. "Data Mining as Exploratory Data Analysis." **Zachary Jones**, *Pennsylvania State University*
31. "Identifying Threats: Using Machine Learning in International Relations." **Azusa Katagiri** and **Eric Min**, *Stanford University*
32. "The Promise of Empirical Computational Models: An Application to Immigration Politics." **Yamil Velez**, *Stony Brook University*
33. "Do As We Do: Using Random Forests to Estimate the Determinants of International Cooperation." **Paul Zachary**, *University of California, San Diego*

Experimental Research

Discussant: **Emily Beaulieu**, *University of Kentucky*

34. "Direct Sports Competition and International Conflict: Evidence from a Randomized Natural Experiment." **Andrew Bertoli**, *University of California, Berkeley*, **Josh Kalla**, *University of California, Berkeley*, and **Baobao Zhang**, *Yale University*
35. "Who Informs on Their Neighbors in Civil Conflict: Evidence from Survey Experiments in Nigeria." **Graeme Blair**, *Princeton University*
36. "Public Goods, Real Taxes and Real Benefits." **Ethan Porter**, *University of Chicago*
37. "Measuring Pre-Treatment Effects in Experiments." **Kimberly Twist**, *University of California, Berkeley*
38. "Analyzing the Effects of Redistricting on Ideology in the Post-Wesberry Era." **Ryan Williamson**, *University of Georgia*

Improving Inferences

Discussant: **Natalie Jackson**, *Huffington Post/Pollster.com*

39. "Assessing the Impact of Systematic Measurement Error on Inference: Sensitivity Analysis Using Beliefs." **Max Gallop** and **Simon Weschle**, *Duke University*
40. "Improving Inferences with Count Outcomes." **Benjamin Kassow**, *Georgia State University*, **Monica Lineberger**, *University of South Carolina*, and **Ali Masood**, *University of South Carolina*
41. "Set-Theoretic Comparative Methods and the Recovery of Data-Generating Processes." **Christopher Krogslund**, *University of California, Berkeley*
42. "Revisiting Hypothesis Testing in the Presence of Multicollinearity." **Richard Morgan** and **Andrew Pierce**, *Emory University*
43. "Improving Transparency and Reliability in Cross-National Analyses." **Jack Paine**, *University of California, Berkeley*

Network Analysis

Discussant: **Justin Kirkland**, *University of Houston*

44. "A Leaderless Movement? Social Networks in the Tea Party." **Rachel Blum**, *Georgetown University*
45. "Policy Collaboration Networks in the House of Representatives." **Alison Craig**, *Ohio State University*
46. "Google Correlations: New Approaches to Collecting Data for Statistical Network Analysis." **Paasha Mahdavi**, *University of California, Los Angeles*
47. "Latino Influence in the House of Representatives: A Social Network Approach." **Lisa Pringle**, *Claremont Graduate University*
48. "Uncovering Common Latent Space from Large Multiple Networks Using Spectral Approach." **Yunkyu Sohn**, *University of California, San Diego*

Text Analysis

Discussant: **Ellen M. Key**, *Appalachian State University*

49. "Exploring the Communicative Environment between Local Elites and Citizens Using a Crossed Random Effects Model." **Bai Linh Hoang**, *University of Michigan*
50. "Estimating The Partisan Bias of Survey Questions Using Congressional Texts." **Aaron Kaufman**, *Harvard University*
51. "North Korea, In Their Own Words: Measuring Foreign Policy Preference Using Text As Data." **John Seungmin Kuk** and **D. Inbok Rhee**, *University of California, San Diego*
52. "Methods for Extremely Large Scale Media Experiments and Observational Studies." **Gary King**, **Benjamin Schneer**, and **Ariel White**, *Harvard University*
53. "Power in Language: A Grammar-Based Approach for Measuring Delegation of Authority." **Robert Shaffer**, *University of Texas*

Time-Referenced Data

Discussant: **Patrick Brandt**, *University of Texas, Dallas*

54. "Flocking Together or Flying Apart? Social Media and the Comparative Dynamics of Mass Political Polarization." **Pablo Barberá**, *New York University*
55. "Best of All Plausible Worlds? Checking Robustness of Time-Series Cross-Sectional Models with Fictitious Plausible Alternate Treatments." **Evangeline Reynolds**, *University of Illinois at Urbana-Champaign*
56. "The Dynamic Battle for Pieces of Pie: Modeling Party Support in Multi-Party Nations." **Andrew Philips** and **Amanda Rutherford**, *Texas A&M University*
57. "Generalized Synthetic Control Method for Causal Inference in Time-Series Cross-Section Data." **Yiqing Xu**, *Massachusetts Institute of Technology*

Faculty Posters (Friday, 2:00pm)

1. "Evaluating the Robustness of Item Count Technique Estimators under Random and Non-Random Measurement Error." **John Ahlquist**, *University of Wisconsin*
2. "Estimating Survival Probabilities When Event-Failure is Imperfectly Detected." **Benjamin Bagozzi**, *University of Minnesota*
3. "Verified Bayesian Computation and Alternatives for Inference in Complex Models." **Bryce Corrigan**, *Cornell University*
4. "Social Networks and Protest Diffusion During the East German Revolution." **Charles Crabtree**, *Pennsylvania State University*, **Christopher Fariss**, *Pennsylvania State University*, and **Holger Kern**, *Florida State University*
5. "Confounding in Survey Experiments." **Allan Dafoe** and **Baobao Zhang**, *Yale University*
6. "The Bias and Efficiency of Internal Local Government Communication Patterns." **Bruce Desmarais**, **Matthew Denny**, and **Hanna Wallach**, *University of Massachusetts, Amherst*
7. "Creating Instrumental Variables from Interaction of Non-instrumental Variables." **Justin Esarey**, *Rice University*
8. "You Lie! Patterns of Partisan Taunting in the U.S. Senate." **Justin Grimmer**, *Stanford University*, **Gary King**, *Harvard University*, and **Chiara Superti**, *Harvard University*
9. "The Hazards of Hazard Ratios: Generating Expected Durations from the Cox Proportional Hazards Model." **Jeff Harden**, *University of Colorado, Boulder* and **Jonathan Kropko**, *University of Virginia*
10. "The Benefits of Sampling Clusters with Probability Proportional to Size in Cluster-Randomized Experiments." **Michael Higgins**, *Princeton University*
11. "Scalable Clustering Algorithm and Visualization Tools for Analyzing 10 Billion Trade Flow Data." **Kosuke Imai**, *Princeton University*, **In Song Kim**, *Massachusetts Institute of Technology*, and **Radhika Saksena**, *Princeton University*
12. "Companion Bill Introductions as Signaling Devices: The Logic of Cross-Chamber Congressional Collaboration." **Justin Kirkland**, *University of Houston*, and **Mary Kroeger**, *Princeton University*
13. "Modeling Preferences Using Legislative Voting in the Presence of Missing Data." **Scott Moser**, *University of Texas*
14. "Varying Responses to Common Shocks and Complex Cross-Sectional Dependence: Dynamic Multilevel Modeling with Multifactor Error Structures for Time-Series Cross-Sectional Data." **Xun Pang**, *Tsinghua University*
15. "Compression and Conditional Effects." **Carlisle Rainey**, *University at Buffalo (SUNY)*
16. "Strengthening Weak Instruments through Identifying Compliers: Complier Instrumental Variable Estimation." **Marc Ratkovic** and **Yuki Shiraito**, *Princeton University*
17. "Validating Data on the Search for Political Information: What Search Behavior Reveals about Attention, Agenda Setting, and Participation." **Jesse Richman**, *Old Dominion University*
18. "Increasing Legislative Agreement: The California Top Two Primary." **Andrew Sinclair**, *Claremont McKenna College*
19. "What the Big Picture Reveals About Governments: Scalable Text Analysis of Millions of Newspapers in China." **Margaret Roberts**, *University of California, San Diego* and **Brandon Stewart**, *Harvard University*
20. "Topical Slant: Estimating Agenda Bias, and Ideological Slant by Topic in News." **Gaurav Sood**, *Stanford University*



THE GEORGIA CENTER'S

UGA HOTEL

and conference center

FIRST FLOOR

Elevators to Conference Rooms, Hotel Rooms, Sanford Boardroom, and Press Box

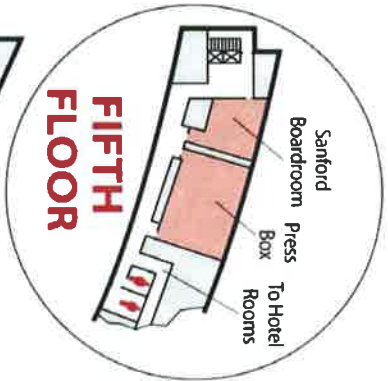
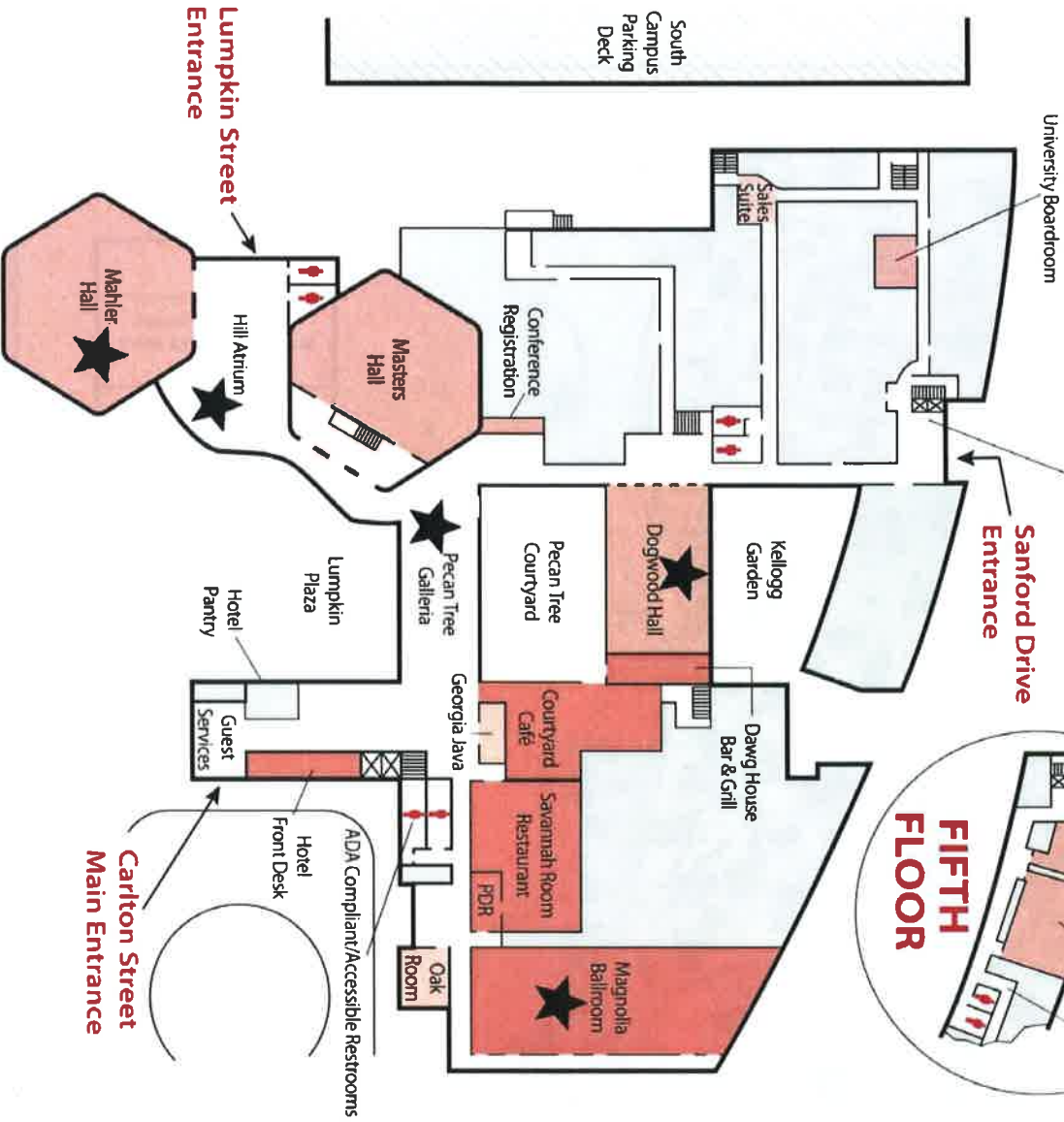

SECOND FLOOR



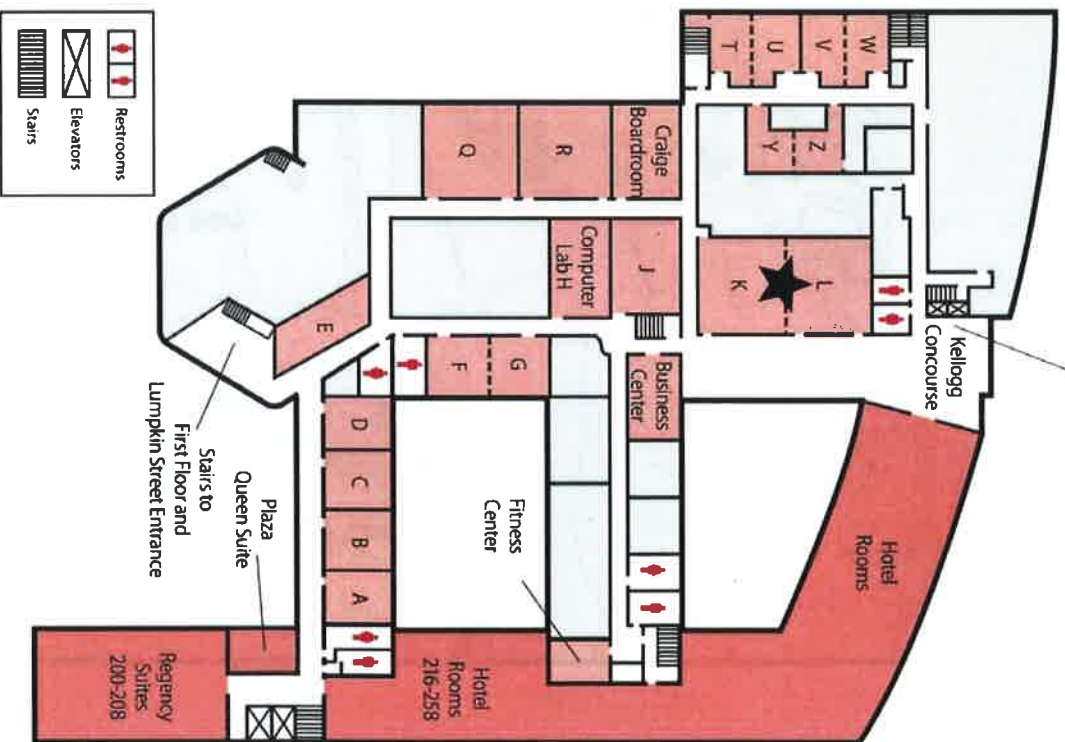

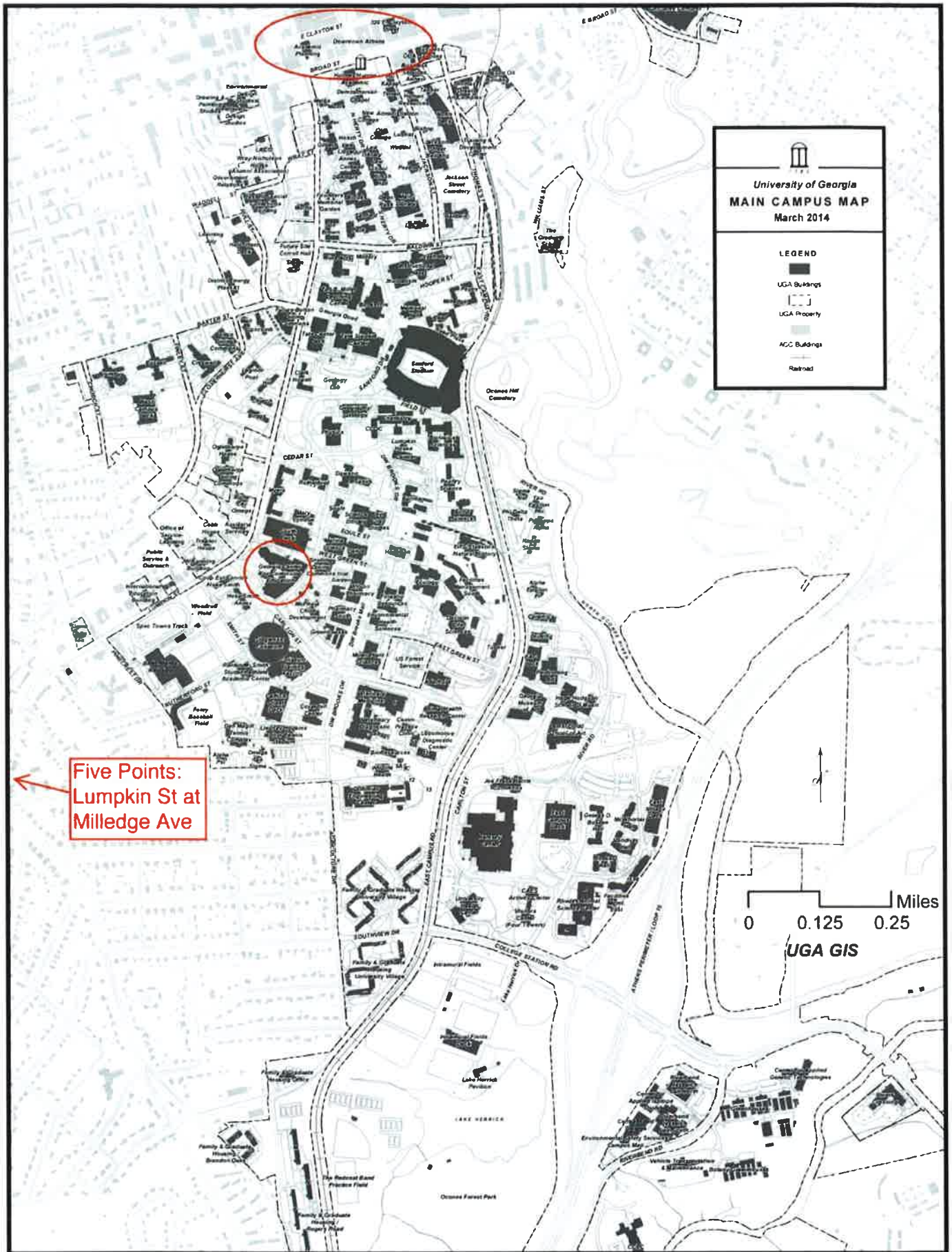
Elevators to 1st Floor, Hotel Rooms, Sanford Boardroom, and Press Box



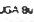

University of Georgia
MAIN CAMPUS MAP
 March 2014

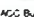
LEGEND

-  UGA Buildings
-  UGA Property
-  AGC Buildings
-  Railroad

Five Points:
 Lumpkin St at
 Milledge Ave

0 0.125 0.25 Miles
UGA GIS